

Ruben Greyson, East Sussex

BA Year 1

Project: Maker Space

The project brief was to design a space that sold, produced, and educated people about our product, in my case charcoal. I built a 1:50 sectional model that not only presents my design, but also acted as a 3D sketchbook to help me develop my design. I also created a second model for exhibition, with which I decided to convey the character of my design, rather than precise dimensions which I had focussed on in my sectional model. There are four parts to this concrete model, which slot together. The connections between these four parts demonstrate the key pathways and tunnels that I was focusing on in my design.

I used concrete in both models. The concrete mix uses: cement that I had left over from gardening projects; some plaster that I found in a skip as aggregate; PVA and washing-up liquid as plasticizer; and powdered home-made charcoal for added texture and colouring.

Atop the concrete plinth of the sectional model stands the rest of the model. The use of the grey card (salvaged from the back of sketchbooks) enables thoughtful and uninhibited experimentation, whilst also allowing a crisp finished product. Balsa wood (which, I confess, is from a shop), as it is easily cut with a scalpel is ideal for home model making, and in the case of this model is very effective in demonstrating the public walkways in contrast to the private.

The exhibit models were inspired by the sculptures of David Umemoto, who I contacted and received advice from regarding the concrete mix to use. I used insulation foam that I found in a nearby skip to create a negative mould. Without a workshop I had to improvise and slowly problem-solve how to piece together the moulds. Through a series of test casts I determined a mix that was strong and then replicated the ratios on a larger scale in the final cast. I used Vaseline to lubricate the mould so it would easily separate from the cast.

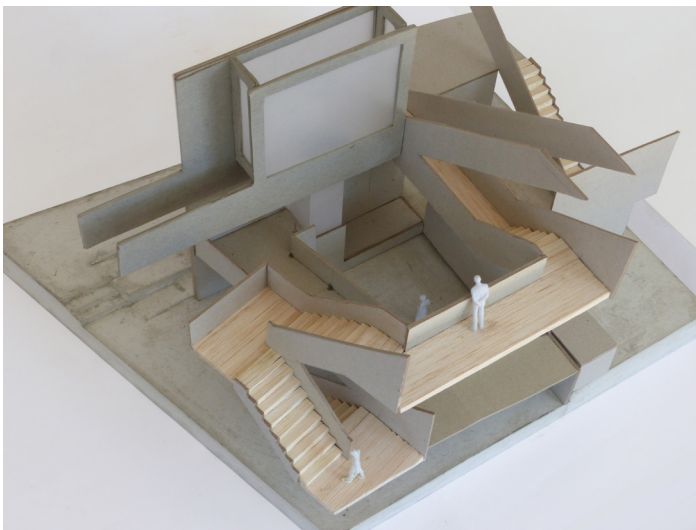

Image 01:
Sectional Model
Both Parts, concrete, grey board, balsa wood, tracing paper

Image 02:
Exhibit Model
View from above of all the four pieces
Concrete





Image 03:
Sectional Model
Concrete Base



Image 04:
Sectional Model
'Public' and 'Private' sections standing apart



Image 05:
Exhibit Model
Connections between the pieces; bridges, ramps and steps



Image 06:
Exhibit Model
Individual piece - sculptural and interesting in its own right